

Specifications:

USB 2.0 optical wireless mouse SBOX
 Resolution: 1000 - 2400 DPI (Changeable)
 Operating distance: 10m
 Micro USB receiver, can be stored inside mouse
 Wireless frequency: 2,4Ghz
 Ideal for using with notebook computers
 Compatibility: Windows XP/Vista/7/8 in Mac OS,
 Plug & Play, Small battery consumption for longer autonomy
 3V 6mA, Key life: 5.000.000 times
 Built in ON/OFF button (on the bottom)
 Battery type for mouse: 2x AAA 1,5V alkaline or 2x AAA 1,2V NI-MH
 (batteries are not included in package)
 Color: Black/Black (Available in Black/Red)
 Package contains: 1x Wireless mouse, 1x Micro USB Receiver, 1x User manual

**Setting up mouse**

1. Put the batteries in the battery compartment under the mouse.
2. Watch for battery polarity. Put the switch to »ON« position.
3. Micro USB receiver is on the bottom right of the blister package.
4. Connect micro USB receiver in the empty USB port.
5. Computer will automatically install necessary drivers.
6. When you don't use mouse put the switch in »OFF« position.
7. Sleep function will activate after 8 min of not using mouse. For deactivate sleep function click any of the keys.

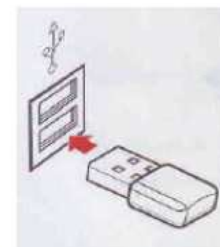

ON/OFF SWITCH

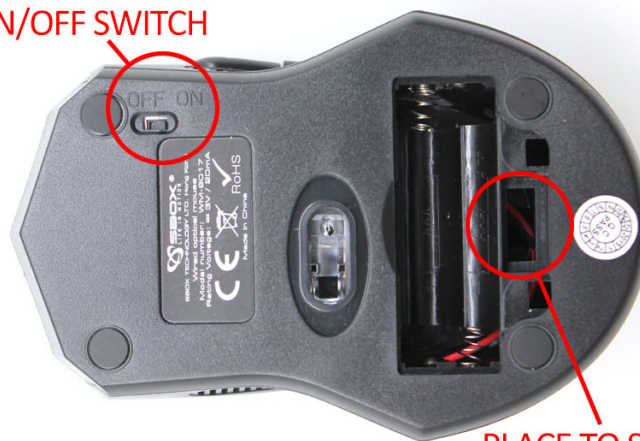

**PLACE TO STORE
MICRO USB RECEIVER**

Warning! Mouse will not work on smooth, glassy or reflective surfaces.

If mouse lose connection with receiver, remove battery, unplug micro USB receiver and connect it in another USB port. Put the batteries back in the mouse and let it connect with receiver again.

Manufacturer headquarter:

SBOX TECHNOLOGY LIMITED, IMPORT, EXPORT, SALES & SERVICE FLAT 906, 9/F., WORKINGPORT COMM. BLDG., 3 HAU FOOK ST. TSIM SHA TSUI, KOWLOON HONG KONG